

LEGEND

ROADWAY

- OPEN CHANNEL
- EMBANKMENT ON FILL
- GUARD RAIL
- CENTRE LINE
- CARRIAGE WAY EDGE
- PAVED SHOULDER EDGE
- SIDE DRAIN
- CUT EMBANKMENT

TOPOGRAPHIC

- MINOR CONTOUR
- MAJOR CONTOUR
- BUILDING
- EXISTING CULVERT

PROFILE

- GRADIENT
- PROPOSED ROAD PROFILE
- EXISTING GROUND PROFILE
- PROPOSED RIGHT OF WAY

PCC 1x900

RC 2x3x2

- CONCRETE PIPE CULVERT 1 CELL 900mm
- CONCRETE BOX CULVERT 2 CELLS, 3M WIDTH BY 3M HEIGHT

Setting Out Points
ARC 1960 (Kenya) _UTM
ZONE 37N

POINT No.	Y (NORTHING)	X (EASTING)
100	51229.0314	370930.1571
101	51218.8018	370943.8822
103	51228.1570	370955.5274
104	51233.6692	370941.8882
105	51211.6284	370934.8130
106	51229.6298	370963.1111
107	51241.6484	370951.2261
108	51233.5963	370855.2447
109	51239.6201	370944.8993
110	51236.5776	370949.9763
111	51255.0004	370958.0615
112	51250.1641	370943.8625
113	51260.7393	370944.1782

SERVICE DUCT

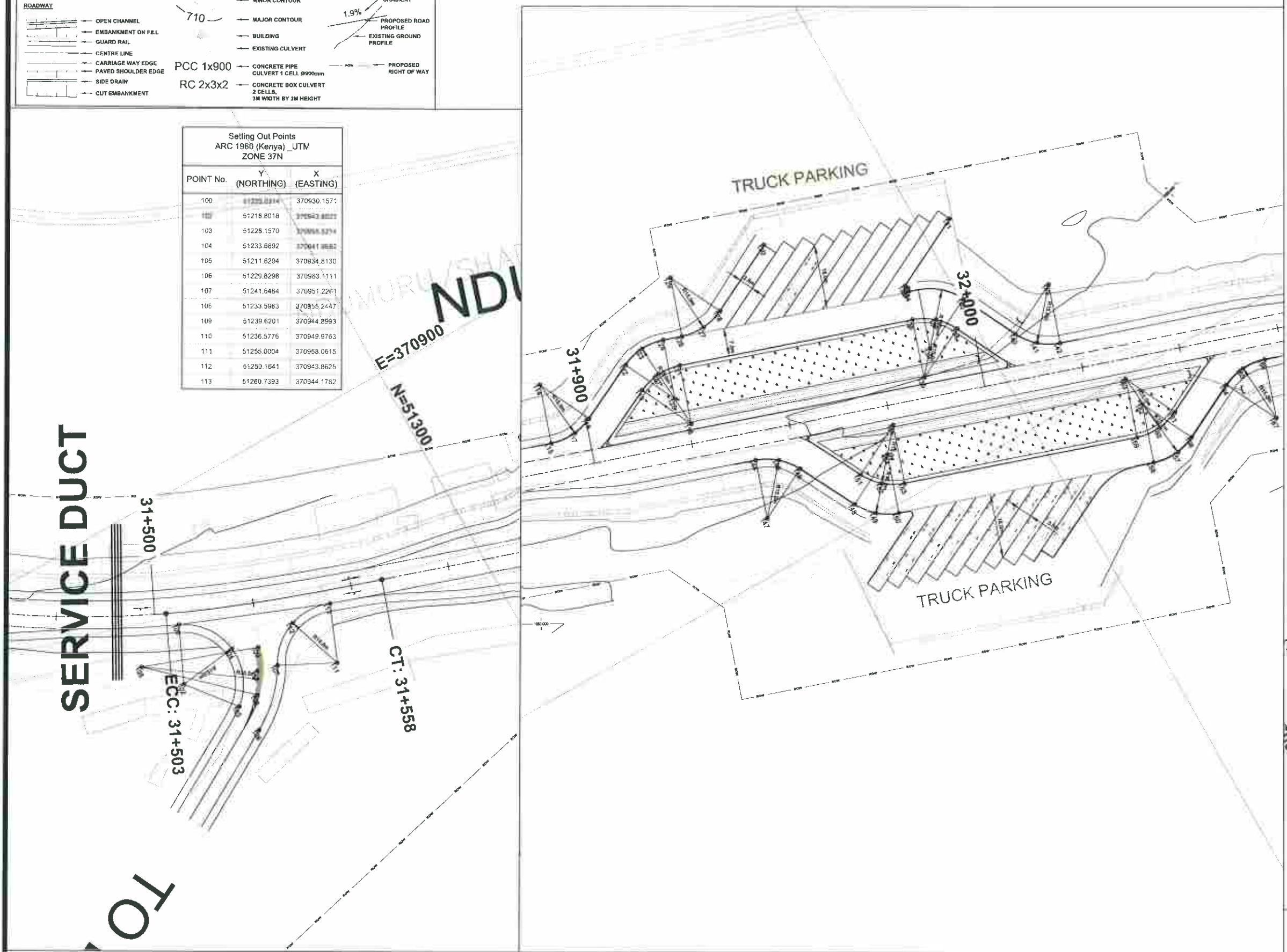

Setting Out Points
ARC 1960 (Kenya) _UTM
ZONE 37N

POINT No.	Y (NORTHING)	X (EASTING)
114	51597.3996	371029.4480
115	51592.6641	371043.8906
116	51603.9649	371042.9349
117	51585.1138	371044.3458
118	51625.7618	371056.7914
119	51616.1805	371043.1105
120	51614.7532	371041.8300
121	51630.4673	371043.9843
122	51618.8885	371025.7575
123	51624.2656	371034.2870
124	51625.8884	371035.8314
125	51622.2538	371044.2945
126	51634.5402	371036.8317
127	51640.3052	371037.2639
128	51646.0054	371026.7084
129	51639.2757	371022.3028
130	51663.7458	371026.6627
131	51707.5973	371043.9513
132	51689.5717	371053.1402
133	51689.9643	371053.9222
134	51669.6880	371054.7524
135	51682.3801	371075.4839
136	51687.2116	371081.3718
137	51680.1037	371084.2717
138	51688.8906	371088.9623
139	51687.2413	371088.8788
140	51700.8870	371083.1771
140	51707.7243	371077.5011
141	51711.3825	371081.8436
142	51716.4086	371084.8824
143	51721.4440	371078.8186
144	51625.8718	371032.8488
145	51640.3043	371078.8887
146	51642.8728	371080.9123
147	51630.8261	371088.8777
148	51651.4676	371094.5722
149	51655.8442	371099.0980
150	51660.0888	371101.9399
151	51656.3853	371088.8311
152	51656.8028	371089.3279
153	51654.8662	371086.1368
154	51664.8044	371087.5078
155	51669.7221	371081.8888
156	51722.0583	371122.5640
157	51728.6620	371123.3400
158	51733.5216	371121.7367
159	51724.8488	371115.0053
160	51727.7101	371115.7008
161	51733.8761	371114.1780
162	51726.7918	371108.3311
163	51726.2483	371100.7724
164	51747.8508	371116.8437
165	51753.3010	371113.0682
166	51754.1180	371113.6164
167	51754.3805	371128.0493

CONSTRUCTION ISSUE
Signed: SLM/DOO

 Howard Humphreys (EA) Ltd an Atkins company 407 WINDYBUSH DRIVE P.O. BOX 30156-00100, NAIROBI Phone 444254/5, 4441635 Fax 4440299	Designed by DMM Checked by JKW Scale V 1:200 H 1:2000 Job No. 5159287 CO STATUS	Drawn by DMM Approved by PNW Date APRIL 2018 ACAD File C-P-054C0 DRAWING No. IK/C/P054 CO REV	 Kenya National Highways Authority KENYA NATIONAL HIGHWAYS AUTHORITY P.O. BOX 48712-00100 NAIROBI	DIRECTOR (DEVELOPMENT) DEPUTY DIRECTOR (DEVELOPMENT)	DATE DATE	ASSISTANT DIRECTOR (DEVELOPMENT) PROJECT ENGINEER	DATE DATE	<table border="1"> <tr> <th>REV</th> <th>REVISIONS</th> <th>SIGN</th> <th>DATE</th> <th>APPROVED</th> </tr> <tr> <td></td> <td>BY</td> <td></td> <td></td> <td></td> </tr> <tr> <td></td> <td>CHECKED</td> <td></td> <td></td> <td></td> </tr> <tr> <td></td> <td>BY</td> <td></td> <td></td> <td></td> </tr> <tr> <td>00</td> <td>CONSTRUCTION ISSUE</td> <td>BY</td> <td>DMM</td> <td>APR18</td> </tr> <tr> <td></td> <td>CHECKED</td> <td></td> <td></td> <td></td> </tr> <tr> <td>P0</td> <td>PRELIMINARY ISSUE</td> <td>BY</td> <td>DMM</td> <td>DEC17</td> </tr> <tr> <td></td> <td>CHECKED</td> <td></td> <td></td> <td></td> </tr> </table>	REV	REVISIONS	SIGN	DATE	APPROVED		BY					CHECKED					BY				00	CONSTRUCTION ISSUE	BY	DMM	APR18		CHECKED				P0	PRELIMINARY ISSUE	BY	DMM	DEC17		CHECKED				Project title CONSULTANCY SERVICES FOR DESIGN REVIEW OF ISILOU-KULAMAWA ROAD (A10 & B84)	Drawing Title JUNCTION & TRUCK PARKING JUNCTION TO LAARE & NDMURUSHAP TRUCK PARKS
	REV	REVISIONS	SIGN	DATE	APPROVED																																													
	BY																																																	
	CHECKED																																																	
	BY																																																	
00	CONSTRUCTION ISSUE	BY	DMM	APR18																																														
	CHECKED																																																	
P0	PRELIMINARY ISSUE	BY	DMM	DEC17																																														
	CHECKED																																																	

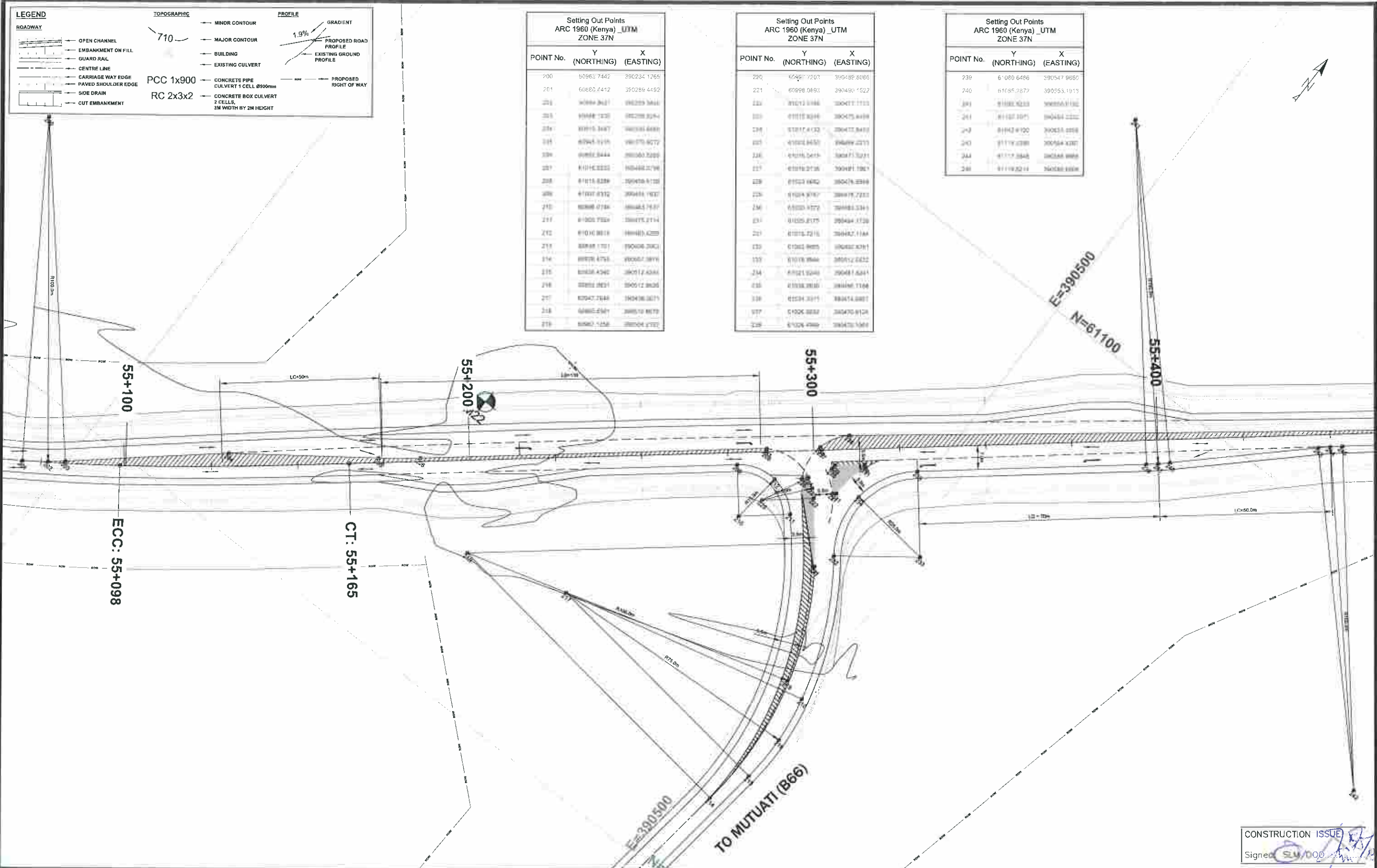

Setting Out Points
ARC 1960 (Kenya) _UTM
ZONE 37N

POINT No.	Y (NORTHING)	X (EASTING)
200	60963.7442	390234.1265
201	60880.4412	390289.4492
202	60899.2621	390259.3661
203	60948.1232	390239.3294
204	60995.3487	390334.6489
205	60945.9195	390379.8272
206	60882.8444	390360.3288
207	61014.8333	390482.1798
208	61115.8289	390458.9128
209	61037.8332	390454.1937
210	60908.8784	390465.7437
211	61003.7229	390479.2114
212	61010.8818	390481.4229
213	60988.1701	390498.2063
214	60978.4755	390507.3819
215	60938.4340	390517.4384
216	60952.8821	390512.8826
217	60947.7648	390496.3871
218	60880.2501	390519.8179
219	60960.1458	390504.4702

Setting Out Points
ARC 1960 (Kenya) _UTM
ZONE 37N

POINT No.	Y (NORTHING)	X (EASTING)
220	60997.7203	390489.8086
221	60998.0693	390490.1522
222	61013.8186	390477.1133
223	61018.8246	390475.8499
224	61017.4132	390472.8492
225	61003.8450	390489.2373
226	61016.5493	390471.3221
227	61016.8138	390481.1867
228	61023.6840	390476.8968
229	61004.9767	390478.7233
230	61003.9372	390483.3341
231	61025.8175	390484.1328
232	61015.7216	390482.1184
233	61003.9805	390482.8381
234	61016.8946	390472.2432
235	61021.8240	390481.8241
236	61018.8810	390486.1188
237	61034.3011	390474.8887
238	61006.8882	390470.8124
239	61026.4980	390470.1581

Setting Out Points
ARC 1960 (Kenya) _UTM
ZONE 37N

POINT No.	Y (NORTHING)	X (EASTING)
239	61080.6486	390547.9885
240	61085.2872	390553.1915
241	61085.8233	390553.1182
242	61107.8975	390484.2222
243	61042.8120	390534.2888
244	61119.4388	390584.4387
245	61117.2848	390584.8888
246	61119.8214	390580.8888

Design Services Engineers
Howard Humphreys(HA) Ltd
an Atkins company
HOWARD HUMPHREYS HOUSE
MULHANGARI DRIVE
P.O. Box 30156-00100, NAIROBI
Phone 4445254/5, 4441835
Fax 4440299

Designed by DMM
Checked by [Signature] Approved by PNW
Scale V1:200 H1:2000 Date APRIL 2018
Job No. 5159287 ACAD File: C-P-055C0
DRAWING No. IKC/P/055

Kenya National Highways Authority
KENYA NATIONAL HIGHWAYS AUTHORITY
P.O. BOX 49712-00100
NAIROBI

DIRECTOR (DEVELOPMENT)	DATE	ASSISTANT DIRECTOR (DEVELOPMENT)	DATE
DEPUTY DIRECTOR (DEVELOPMENT)	DATE	PROJECT ENGINEER	DATE

REV	REVISIONS	SIGN	DATE	APPROVED
	BY [Signature]			
	CHECKED [Signature]			
	BY [Signature]			
	CHECKED [Signature]			
C0	CONSTRUCTION ISSUE	BY DMM	APR 18	[Signature]
P0	PRELIMINARY ISSUE	BY DMM	DEC 17	

Project title
CONSULTANCY SERVICES FOR DESIGN REVIEW OF
ISIOLO-KULAMAWE ROAD (A10 & B64)

Drawing Title
JUNCTION
A10/B66 JUNCTION

CONSTRUCTION ISSUE
Signed [Signature]

LEGEND

ROADWAY

- OPEN CHANNEL
- EMBANKMENT ON FILL
- GUARD RAIL
- CENTRE LINE
- CARRIAGE WAY EDGE
- PAVED SHOULDER EDGE
- SIDE DRAIN
- CUT EMBANKMENT

TOPOGRAPHIC

- MINOR CONTOUR
- MAJOR CONTOUR
- BUILDING
- EXISTING CULVERT

PROFILE

- GRADIENT
- PROPOSED ROAD PROFILE
- EXISTING GROUND PROFILE

PROPOSED RIGHT OF WAY

- PCC 1x900
- RC 2x3x2
- CONCRETE PIPE CULVERT 1 CELL Ø900mm
- CONCRETE BOX CULVERT 2 CELLS, 3M WIDTH BY 2M HEIGHT

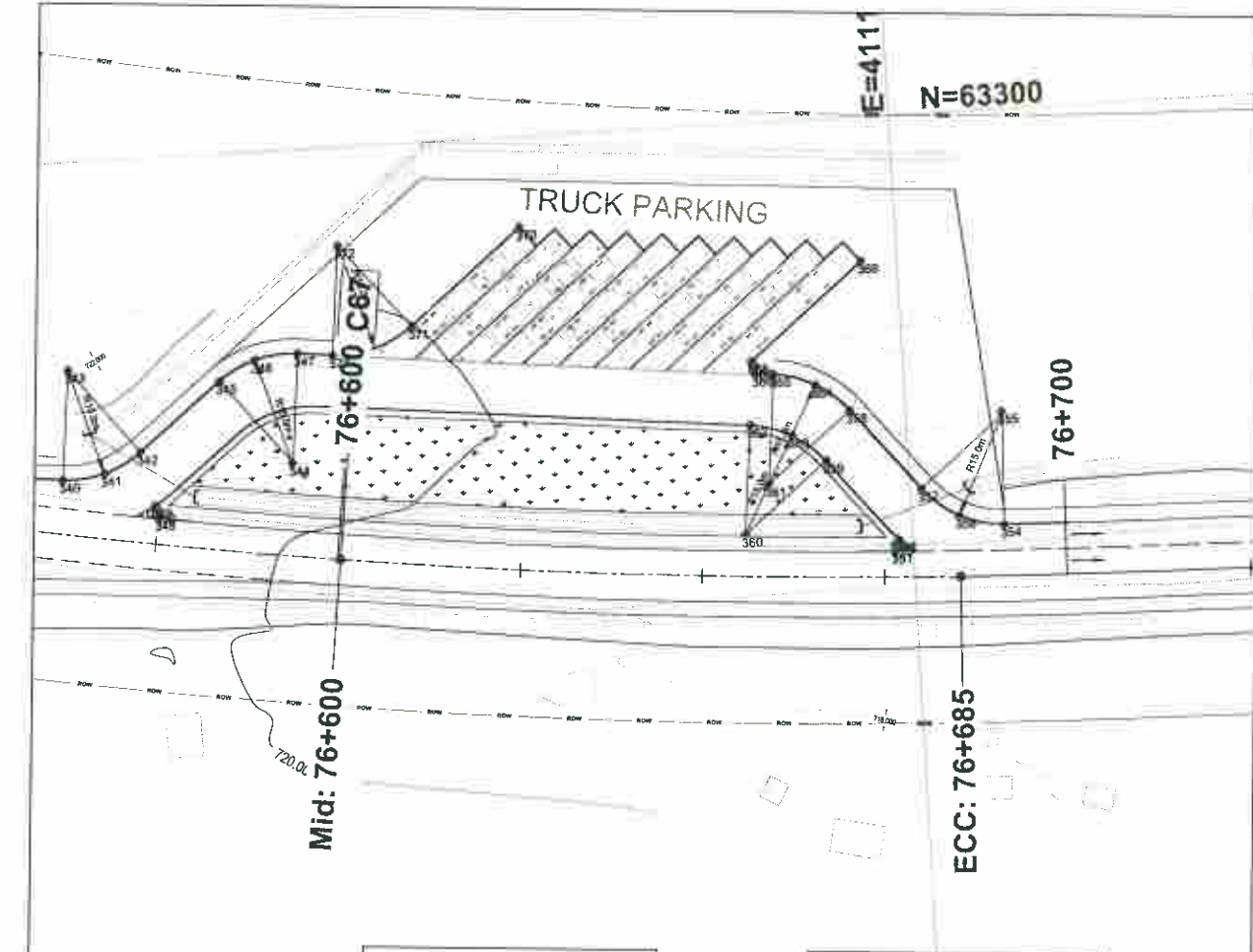
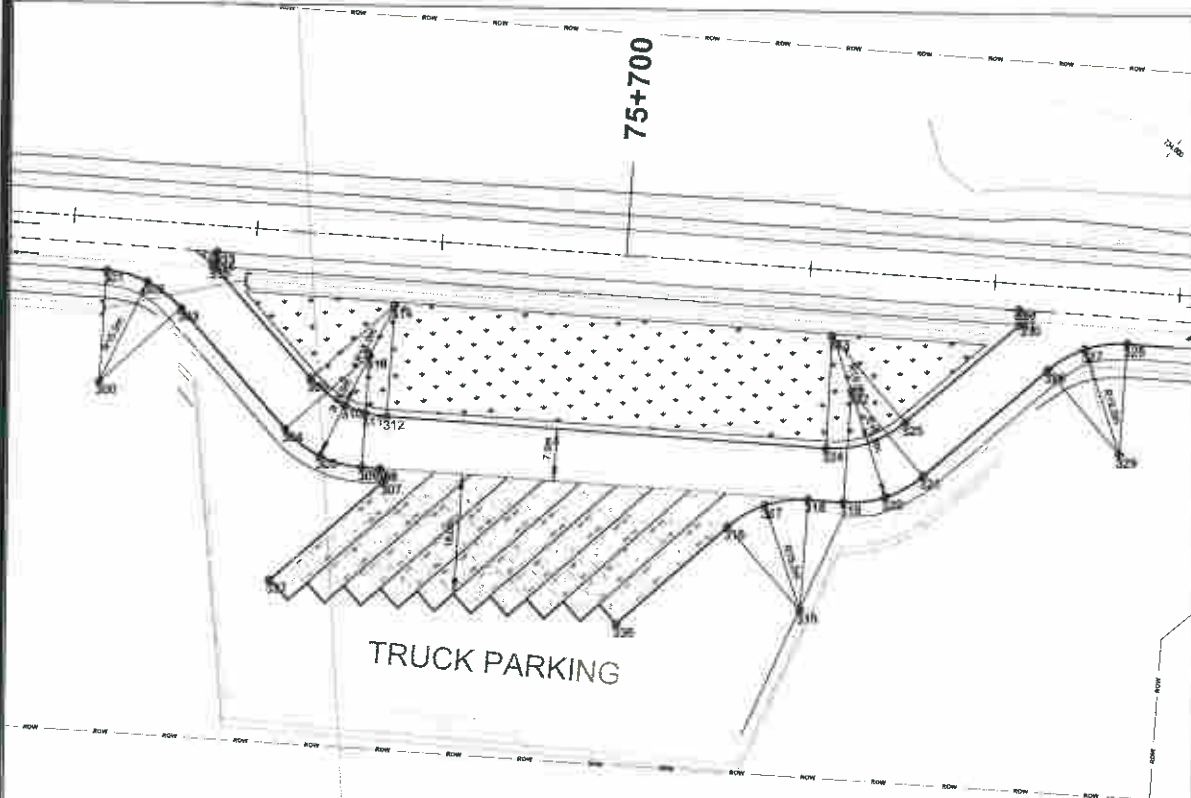

Setting Out Points
ARC 1980 (Kenya) _UTM
ZONE 37N

POINT No.	Y (NORTHING)	X (EASTING)
300	63420.3274	410070.1688
301	63425.2056	410072.0838
302	63433.3385	410077.8159
303	63429.4889	410062.0547
304	63412.4881	410088.1373
305	63408.6361	410099.5531
306	63404.7881	410105
307	63404.8743	410108
308	63406.4058	410107
309	63418.3618	410088
310	63417.2588	410101
311	63417.0837	410106.0251
312	63413.3427	410108.8792
313	63411.8472	410107.8179
314	63428.2288	410116.7883
315	63384.1879	410163.2394
316	63396.6819	410158.3018
317	63399.0660	410169.1487
318	63396.4557	410169.5484

Setting Out Points
ARC 1980 (Kenya) _UTM
ZONE 37N

POINT No.	Y (NORTHING)	X (EASTING)
320	63386.8359	410175.8633
321	63401.3618	410180.8515
322	63413.3357	410171.8142
323	63420.8410	410169.6062
324	63405.7619	410167.9656
325	63408.9888	410175.8118
326	63414.6748	410198.4875
327	63417.2006	410203.6758
328	63417.5809	410209.4337
329	63402.7028	410207.5249
330	63421.1714	410195.4753
331	63421.9695	410194.8728
332	63422.8614	410195.0001
333	63426.7777	410207.2128
334	63425.1890	410207.1894
335	63424.8761	410208.5670
336	63385.6822	410138.2888
337	63392.3104	410091.8538

Setting Out Points
ARC 1980 (Kenya) _UTM
ZONE 37N

POINT No.	Y (NORTHING)	X (EASTING)
340	63256.6729	410084.1534
341	63257.1885	410084.9773
342	63259.8550	410995.0746
343	63271.5897	410985.7513
344	63257.1776	411015.7933
345	63268.9123	411006.4500
346	63271.5386	411011.4618
347	63277.2888	411017.3176
348	63281.7744	410997.0430
349	63252.5067	410896.6784
350	63261.6393	410997.1760
351	63240.5118	411097.4846
352	63242.0261	411098.1256
353	63241.8887	411097.5293
354	63241.2288	411112.6827
355	63241.8838	411113.1828
356	63244.7821	411106.5148
357	63248.7571	411107.5838
358	63260.0008	411092.4230
359	63253.3332	411086.8229

Setting Out Points
ARC 1980 (Kenya) _UTM
ZONE 37N

POINT No.	Y (NORTHING)	X (EASTING)
360	63248.0708	411077.1834
361	63250.3383	411060.7838
362	63251.7025	411078.7077
363	63252.2770	411084.3091
364	63252.7967	411087.0082
365	63253.2819	411082.3871
366	63265.7109	411079.8668
367	63266.7007	411076.8884
368	63267.2854	411076.3360
369	63260.3345	411058.1634
370	63267.2854	411048.0423
371	63276.2054	411053.8882
372	63286.5288	411053.8130
373	63287.1126	411022.0888

CONSTRUCTION ISSUE
Signed: [Signature]

Design Review Engineers
Howard Humphreys (SA) Ltd
an Atkins company
KINSHASA COMPANY HOUSE
MUTHANGARI DRIVE
P.O. Box 30156-00100, NAIROBI
Phone: 445254/5, 4441833
Fax: 4440285

Designed by DMM	Drawn by DMM
Checked by JKW	Approved by PNW
Scale V1:200 H1:2000	Date APRIL 2018
Job No. 5159287	ACAD File: C-P-056C0
CO STATUS	DRAWING No. IKC/P1056
	CO REV

KONHA Kenya National Highways Authority
KENYA NATIONAL HIGHWAYS AUTHORITY
P.O BOX 49712-00100
NAIROBI

DIRECTOR (DEVELOPMENT)	DATE	ASSISTANT DIRECTOR (DEVELOPMENT)	DATE
DEPUTY DIRECTOR (DEVELOPMENT)	DATE	PROJECT ENGINEER	DATE

REV	REVISIONS	SIGN	DATE	APPROVED
	BY [Signature]			
	CHECKED [Signature]			
	BY [Signature]			
	CHECKED [Signature]			
CO	CONSTRUCTION ISSUE	BY DMM	APR'18	[Signature]
PO	PRELIMINARY ISSUE	BY DMM	DEC'17	
	CHECKED [Signature]			

Project Title
CONSULTANCY SERVICES FOR DESIGN REVIEW OF
ISIOLO-KULAMAWE ROAD (A10 & B84)

Drawing Title
TRUCK PARKING
KULAMAWE TRUCK PARKS